

**Feature**

- § Low Power Consumption
- § High Intensity
- § I.C. compatible

**Applications**

- § Commercial Outdoor Sign Board
- § Front Panel Indicator

**Description**

- § The (1)Red and (2)Green Chips are Matched For uniform Light Output
- § Diffusion Lens

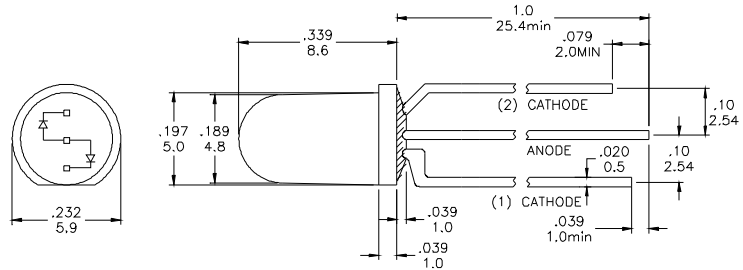
**Package Dimension**

\*Tolerance :  $\pm \frac{0.01}{0.25}$  Unit :  $\pm \frac{\text{inch}}{\text{mm}}$

**Absolute Maximum Ratings at Ta = 25°C**

Symbol	Parameter	Max.	Unit
PD	Power Dissipation	100	mW
VR	Reverse Voltage	5	V
IAF	Average Forward Current	30	mA
IPF	Peak Forward Current ( Duty=0.1 , 1kHz )	100	mA
—	Derating Linear Form 25°C	0.4	mA / °C
Topr	Operating Temperature Range	- 40 to + 80	°C
Tstg	Storage Temperature Range	- 40 to + 100	°C
Lead Soldering Temperature [1.6mm (0.063inch) From Body] 260°C For 5 Seconds.			

**Electrical / Optical Characteristics and Curves at Ta = 25°C**

Symbol	Parameter	Test Condition	Min.	Typ.	Max.	Unit
VF	Forward Voltage	IF= 20 mA	R	2.0		V
			G	3.2		
IR	Reverse Current	VR= 5 V			50	μA
$\Delta \theta$	Half Intensity Angle	IF= 20 mA		50		deg
IV	Luminous Intensity	IF= 20 mA	R	1300		mcd.
			G	1300		
$\lambda P$	Dominant Wavelength	IF= 20 mA	R	625		nm
			G	528		



## BI-COLOR LED LAMP

### AOB-5JRPGTS2-A

**Intensity:** Tolerance of minimum and maximum =  $\pm 15\%$

**Vf:** Tolerance of minimum and maximum =  $\pm 0.05\text{v}$

**NOTE:**

1. Static electricity and surge damages the LED. It is recommend to use a anti-static wrist band or anti-electrostatic glove when handing the LEDs. All devices, equipment and machinery must be properly grounded.

### Radiation Diagram

**IF=20 mA    50% Power Angle    Angle =50°**

Radiation Diagram

